

安可治陰道栓劑

Albothyl® Vaginal Suppositories

(衛署藥輸字第016229號)

主成份：Policresulen

組成份：1粒陰道栓劑含量：policresulen 90mg.

適應症：子宮糜爛、子宮頸炎(含由毛滴蟲及念珠菌引起者)、陰道炎、白帶。

配合禁忌：

懷孕期，Albothyl給藥應考慮其對母親及胎兒之絕對必需性時才可給藥。

動物實驗並未有任何畸胎報告顯示。

研究至目前尚無法說明懷孕婦女的給藥的危險性，尚且不知是否主成份會排於授乳婦的乳汁內。

副作用：

在以Albothyl治療初期會有局部刺激作用，但通常迅速地消退。

藥物交互作用：

Albothyl僅能局部使用，在治療期間補不可使用其他的局部使用製劑於同樣部位。以避免藥物交互反應。

用法、用量：

本藥須由醫師處方使用

未經稀釋濃縮液主要用於灼療子宮頸糜爛和子宮頸內膜：每周1-2次，用時以陰道窺視器，包敷鉗，棉花球等物為助。在塗擦前用少許濃縮液抹去子宮頸內膜和子宮頸頭之粘液，再用吸滿濃縮液之棉球置於患處13分鐘，然後再清除。次法可用濃縮液或1:1至1:5之稀釋液作陰道浴(Menge's Bath)，而二次灼療間以陰道栓劑或凝膠作輔助治療。止血時以浸吸藥液的棉塞壓於流血的地方12分鐘。

安可治陰道栓劑：

陰道栓劑用於二次灼療間，如果栓劑由醫師塞入時，應使用棉塞加於陰道內以防止藥物之變位，棉塞於用藥後12小時由患者自行取出。若栓劑由患者自己使用時，應在臨休息前插入並配帶衛生墊。

指示如何由膠膜中取出Albothyl栓劑。

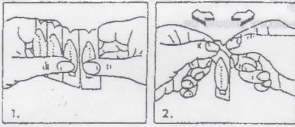

特別注意事項：

1. Albothyl會在治療過程中產生刺激作用。如果壞死組織由病性脫落，即使是大量時，無需驚恐。
2. 在治療期時不可用刺激性肥皂清洗或性交。
3. 與其他陰道製劑一樣，Albothyl在月經來時不可使用。
4. 應避免眼部接觸Albothyl。
5. 如有棉織物及皮革與Albothyl接觸後，必須在製劑未乾前立即洗乾淨。
6. 陰道栓劑上的斑點，是栓劑基劑產生的自然現象，不影響其使用，效果或耐受性。

注意：

過期的Albothyl不可使用。

Albothyl應保存於不超過25度的室溫中。

藥物應置放於孩童拿不到之處。

包裝：

Albothyl栓劑：6~1000粒裝。

製造廠：Nycomed GmbH

廠址：Robert-Bosch-Str.8, D-78224 Singen, Germany

藥商：瑞慶藥業有限公司

地址：台北市南京西路30號8F-3

電話：(02)25501226

ALBOTHYL

Composition
Active principle: policresulen

1 vaginal suppository contains:
Policresulen 90 mg

Indications
Local treatment of inflammation or infection and tissue damage of vagina and cervix le-g. discharge due to Sores from pessaries. Condylomata acuminata etc. Proluberonce of cervical mycosa (cervical ectopia)

Contraindications
During pregnancy,Albolhyl should only be administered if absolutely necessary taking into account all the possible risks for mother and child.
Animal experiments have failed to indicate any major risks on the risk of the application to pregnant women
Are not available It is not known whether the active principle is excreted in the milk of nursing mothers.

Side Effects
Local irritation is occasionally observed at the beginning of treatment with Alborthyl, but usually subsides rapidly

Interactions with other drugs
Alborthyl is exclusively for local use. During therapy no other topical agent should be applied to the same region, as drug interactions cannot be excluded.

Dosage and administration
If not prescribed otherwise:

1 vaginal suppository should be used every second day.
If Alborthyl concentrate has been used, 1 vaginal suppository should be

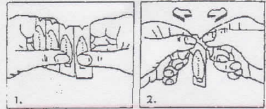

- Special notes
1. Alborthyl brings about stimulation of the healing process. There is no reason to be anxious when necrotic tissue, even in large quantities, is sloughed from the diseased area.
 2. The patient must not wash with irritant soaps or have sexual intercourse during the treatment period.
 3. Like every other vaginal medicament, Alborthyl should not be used during menstruation.
 4. Keep the eyes protected from Alborthyl.
 5. After contact with Alborthyl, all textiles and leather should be rinsed with water before the preparation has had time to dry.
 6. The flecked appearance of the vaginal suppositories is due to the suppository base, and has no effect on its applicability, effectiveness or tolerability.

Note
Alborthyl should not be used beyond the date of expiry
Alborthyl has to be stored below 25°C

Keep all medicaments out of the reach of children!

Presentation
Alborthyl Vaginal Suppositories
Packs of 6 and 1000

introduced into the vagina every second day during intervals between cauterizations. To facilitate its introduction, the suppository may be moistened with water and then, preferably with patient in the supine position, introduced deep into the vagina.
A night-time application of the vaginal suppositories is the most practical. The additional use of a sanitary towel avoids the soiling of clothing and bedding.
Instruction how to withdraw Alborthyl vaginal suppositories from the foil